

MILKLINE[®]

Evolve Conventional Milking

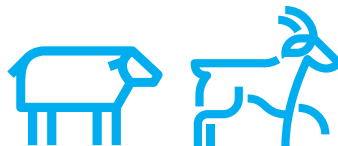

Milking trolleys for sheep and goats

Freedom to milk, comfort everywhere



For 50 years, Milcline has been designing and manufacturing **MADE IN ITALY** milking trolleys.

From the sturdy frame to the precision-engineered vacuum tank, pumps, and milking units, every component is designed and built in our own workshops.

Every detail is carefully selected and assembled to deliver durable, high-performance products that stand the test of time.

“Whether you need a simple, cost-effective solution or a high-performance system capable of milking 2 to 4 animals simultaneously, Milcline offers tailored solutions that meet every farmer’s needs—**always in full compliance with technical and regulatory standards.**”

Features

- Versatile – solutions for every need
- Agile – lightweight, reaches anywhere
- Compact & Efficient – maximum performance in minimal space
- Crafted to Perfection – artisanal quality and attention to detail
- **MADE IN ITALY**



Reliable & Durable



Gentle Milking



Lightweight & Easy to Handle

Our milking trolleys range

Precision milking, perfectly designed for your farm!

Milkline has designed a range of milking trolleys to meet all the needs of sheep and goats farmers.

By combining three main chassis options with different types of vacuum tanks, pumps and milking units, we offer a range of solutions suitable both for small farms that rely on a milk trolley to milk all their animals, and for large farms that want a milk trolley available to milk animals in the infirmary or those separated from the flock for special needs.

ECONOMY



1 ANIMAL

↓

Pag. 4-5

COMPACT



1 ANIMAL

↓

Pag. 6-7

FLEXI2



2 ANIMALS

↓

Pag. 8-13

FLEXI4



4 ANIMALS

↓

Pag. 14-15



COMPONENTS AND SPARE PARTS

→ Pag. 16-24

Example of milking trolley description

Model	Animal N°	Animal	Pump Liter	Pump*	Claw	Bucket N°	Bucket Type**	Bucket Liter
FLEXI	2	S	190	D	ML/OC150	1	P	30
FLEXI	4	G	450	L	PAST	2	I	25

Animal: C (Cow and Buffalo) - S (Sheep) - G (Goat)

Variants:

*Pump type: D (Dry) - L (Lubricated) – **Bucket material: P (Plastic) - I (Stainless steel)

ECONOMY



1 ANIMAL



DRY



1S 140D PAST1P30

With plastic bucket

CODE B90583900

1S 140D PAST1I25

With stainless steel bucket

CODE B90583902



1G 140D PAST1P30

With plastic bucket

CODE B90583950

1G 140D PAST1I25

With stainless steel bucket

CODE B90583952

Features

The **Economy** model represents the best value-for-money solution for milking one animal at a time.

The lightweight and maneuverable frame houses an integrated **5-liter vacuum tank**.

This model is equipped with a maintenance-free **dry vacuum pump (model PM3) delivering 140 L/min of vacuum**.

The **Milkline-patented Pastore claw** is equipped with a special lever that allows you to choose between three operating modes: active vacuum, inactive vacuum, and automatic vacuum. The automatic vacuum mode automatically opens the vacuum only when the liners are attached to the animal's udder. At the end of milking, with a simple movement of the lever, the operator closes the vacuum for easy removal of the cluster.

The **ML120 pneumatic pulsator** is mounted on the bucket lid, and the 2.5-meter vacuum hose connecting the pump to the pulsator allows the operator to detach the bucket from the trolley and approach the animal directly, without needing to move the entire unit.

The **Economy** model is available with either **1 transparent plastic bucket or stainless steel bucket**.

The daily cleaning brush kit is included as standard and comprises: two straight brushes (40 cm and 200 cm) and one short rotating brush.

Technical specifications of key components (Additional spare parts: page 16–24)

CODE	DESCRIPTION	SPECIFICATIONS	Q.TY	PAGE
B0170631	ML LONG CURVED SIL. LINER FOR SHEEP Ø17	SILICON, LONG, CURVED (FOR CODE B90583900/902)	2	16
B0170742	ML LONG CURVED SIL. LINER FOR GOAT TG 20	SILICON, LONG, CURVED (FOR CODE B90583950/952)	2	16
B0416000	PASTORE AUTOMATIC SHEEP AND GOAT CLAW	FOR SHEEP AND GOATS, PLASTIC, WITH AUTOMATIC VALVE, 100 CC CAP.	1	17
B0461786	MILKING BUCKET TRAS 30 L STD BLUE	TRANSPARENT PLASTIC, WITH HANDLE, 30 L CAP., BLUE BOTTOM (FOR CODE B90583900/950)	1	19
M3462001	25 LT STAINLESS STEEL MILK BUCKET	S/S, WITH HANDLE, 25 L CAP. (FOR CODE B90583902/952)	1	19
B0231600	NAKED TRANSPARENT LID	PLASTIC, Ø 19 MM	1	19
B02620301	RUBBER MILK TUBE ML WHITE LINE 13X23	RUBBER, WHITE LINE, MILK TUBE	1,5 M*	18
B0270683	PVC TRANSPARENT VACUUM TUBE ML BLUE LINE 7,6X14,6	PVC, TRANSPARENT, BLUE LINE, VACUUM TUBE (FROM THE PULSATOR TO THE MILKING UNIT) (FROM THE CLAW TO THE SHELL)	2,5 M* 0,3 M X 2*	18
B02816501	RUBBER VACUUM TUBE ML BLU LINE 13X23	RUBBER, BLUE LINE, VACUUM TUBE	2,5 M*	18
B0474010	ELECTRIC VACUUM PUMP PM3 230 KW0,37 / 140L/M	PM3 MODEL, DRY, 230V, KW 0,37, CAPACITY 140 L/MIN - 50KPA - 1.400 RPM	1	21
M0481631	VACUUM GAUGE 63X1/4" DAMPENED	63 X 1/4"	1	24
B0390003	ALTERNATE PULSATOR ML120 50/50	PNEUMATIC, PULSATION RATIO 50/50	1	20
IR 15402	WHEEL	RIGID PLASTIC, Ø 250 MM, WITH CAP	2	24

* Total length (in meters) supplied per trolley.



CODE B90583900



CODE B90583950

ECONOMY



1 ANIMAL



It is possible to milk with the bucket placed far from the frame.



CODE B90583902



CODE B90583952



Included

- Brush kit



COMPACT



1 ANIMAL



1S 140D PAST 1 P30

With plastic bucket

CODE M90580303

1S 140D PAST 1 I25

With stainless steel bucket

CODE M90580304



1G 140D PAST 1 P30

With plastic bucket

CODE M90580301

1G 140D PAST 1 I25

With stainless steel bucket

CODE M90580302

Features

The **Compact** model represents the simplest and most space-efficient solution for milking one animal at a time.

Its streamlined, essential frame design houses an integrated **12-liter galvanized vacuum tank**.

This model is equipped with a maintenance-free **dry vacuum pump (Model PM3) delivering 140 L/min of vacuum**.

The **Milkline-patented Pastore claw** is equipped with a special lever that allows you to choose between three operating modes: active vacuum, inactive vacuum, and automatic vacuum. The automatic vacuum mode automatically opens the vacuum only when the liners are attached to the animal's udder. At the end of milking, with a simple movement of the lever, the operator closes the vacuum for easy removal of the cluster.

The **ML120 pneumatic pulsator**—simple, reliable, and purely air-operated—requires no electrical power supply for operation.

The **Compact** model is available with either **1 transparent plastic bucket or stainless steel bucket**.

The daily cleaning brush kit is included as standard and comprises: two straight brushes (40 cm and 200 cm) and one short rotating brush.

Technical specifications of key components (Additional spare parts: page 16–24)

CODE	DESCRIPTION	SPECIFICATIONS	Q.TY	PAGE
B0170631	ML LONG CURVED SIL. LINER FOR SHEEP Ø17	SILICON, LONG, CURVED (FOR CODE M90580303/304)	2	16
B0170742	ML LONG CURVED SIL. LINER FOR GOAT TG 20	SILICON, LONG, CURVED (FOR CODE M90580301/302)	2	16
B0416000	PASTORE AUTOMATIC SHEEP AND GOAT CLAW	FOR SHEEP AND GOATS, PLASTIC, WITH AUTOMATIC VALVE, 100 CC CAP.	1	17
B0461786	MILKING BUCKET TRAS 30 L STD BLUE	TRANSPARENT PLASTIC, WITH HANDLE, 30 L CAP., BLUE BOTTOM (FOR CODE M90580303/301)	1	19
M3462001	25 LT STAINLESS STEEL MILK BUCKET	S/S, WITH HANDLE, 25 L CAP. (FOR CODE M90580304/302)	1	19
B0231810	ML NAKED TRANSPARENT LID 2 INLETS Ø17	TRANSPARENT PLASTIC, 2 INLETS Ø17 MM	1	19
B02620301	RUBBER MILK TUBE ML WHITE LINE 13X23	RUBBER, WHITE LINE, MILK TUBE	2,15 M*	18
B0270683	PVC TRANSPARENT VACUUM TUBE ML BLUE LINE 7,6X14,6	PVC, TRANSPARENT, BLUE LINE, VACUUM TUBE (FROM THE PULSATOR TO THE MILKING UNIT) (FROM THE CLAW TO THE SHELL)	2,5 M* 0,3 MX2*	18 18
B02816501	RUBBER VACUUM TUBE ML BLU LINE 13X23	RUBBER, BLUE LINE, VACUUM TUBE	0,5 M*	18
B0474010	ELECTRIC VACUUM PUMP PM3 230 KW0,37 /140L/M	PM3 MODEL, DRY, 230V, KW 0,37, CAPACITY 140 L/MIN - 50KPA - 1.400 RPM	1	21
M0481631	VACUUM GAUGE 63X1/4" DAMPENED	63 X 1/4"	1	24
B0390003	ALTERNATE PULSATOR ML120 50/50	PNEUMATIC, PULSATION RATIO 50/50	1	20
IR 15402	WHEEL	RIGID PLASTIC, Ø 250 MM, WITH CAP	2	24

* Total length (in meters) supplied per trolley.



CODE M90580303



CODE M90580301

COMPACT



1 ANIMAL



CODE M90580304



CODE M90580302



Included

- Brush kit



FLEXI2



2 ANIMALS



2S 190D ML/OC150 1P30
With plastic bucket

COD. M90584405

2S 190D ML/OC150 1I25
With stainless steel bucket

COD. M90584406



2G 190D ML/OC150 1P30
With plastic bucket

COD. M90584503

2G 190D ML/OC150 1P30
With stainless steel bucket

COD. M90584504

Features

This version of the **Flexi** trolley is designed for single-animal milking operations, featuring a robust and reliable frame construction.

The **15-liter galvanized vacuum tank** serves as both the vacuum reservoir and the mounting base for the maintenance-free **dry vacuum pump (Model PM4)**, which delivers **190 L/min of vacuum**.

The **ML/OC claw**, thanks to its increased capacity (150 cc), ensures effective outflow of high flows while maintaining vacuum stability. Lightweight and easy to handle, it makes the attachment phase simple and effortless.

The **ML120 pneumatic pulsator**—simple, reliable, and purely air-operated—requires no electrical power supply for operation.

The **Flexi** model is available with either **1 transparent plastic bucket or stainless steel bucket**.

The daily cleaning brush kit is included as standard and comprises: two straight brushes (40 cm and 200 cm) and one short rotating brush.

Technical specifications of key components (Additional spare parts: page 16–24)

CODE	DESCRIPTION	SPECIFICATIONS	Q.TY	PAGE
B0170631	ML LONG CURVED SIL. LINER FOR SHEEP Ø17	SILICON, LONG, CURVED (FOR CODE M90584405/406)	4	16
B0170742	ML LONG CURVED SIL. LINER FOR GOAT TG 20	SILICON, LONG, CURVED (FOR CODE M90584503/504)	4	16
B0410522	ML/OC CLAW 150 W/VW/H	FOR SHEEP AND GOATS, PLASTIC, WITH VALVE, WITH HOLE, 150 CC CAP.	2	16
B0461786	MILKING BUCKET TRAS 30 L STD BLUE	TRANSPARENT PLASTIC, WITH HANDLE, 30 L CAP., BLUE BOTTOM (FOR CODE M90584405/503)	1	19
M3462001	25 LT STAINLESS STEEL MILK BUCKET	S/S, WITH HANDLE, 25 L CAP. (FOR CODE M90584406/504)	1	19
B0231830	ML NAKED TRANSPARENT LID 3 INLETS Ø17	TRANSPARENT PLASTIC, Ø 17 MM, 3 INLETS	1	19
B02620301	RUBBER MILK TUBE ML WHITE LINE 13X23	RUBBER, WHITE LINE, MILK TUBE	5,0 M*	18
B0270683	PVC TRANSPARENT VACUUM TUBE ML BLUE LINE 7,6X14,6	PVC, TRANSPARENT, BLUE LINE, VACUUM TUBE	1,12 M*	18
B0281602	VACUUM TUBE RUB ML BLUE L. 07X14	RUBBER, BLUE LINE, VACUUM TUBE	5,4 M*	18
B02816501	RUBBER VACUUM TUBE ML BLU LINE 13X23	RUBBER, BLUE LINE, VACUUM TUBE	0,5 M*	18
B0474020	ELECTRIC VACUUM PUMP PM4 230 KW0,75 / 190L/M	PM4 MODEL, DRY, 230V, KW 0,75, CAPACITY 190 L/MIN - 50KPA - 1.400 RPM	1	21
M0481631	VACUUM GAUGE 63X1/4" DAMPENED	63 X 1/4"	1	24
B0390003	ALTERNATE PULSATOR ML120 50/50	PNEUMATIC, PULSATION RATIO 50/50	1	20
IR15402	WHEEL	RIGID PLASTIC, Ø 250 MM, WITH CAP	2	24

* Total length (in meters) supplied per trolley.



CODE M90584405



CODE M90584503

FLEXI2



2 ANIMALS



DRY



PM4
190L/MIN



15 LITER
TANK



CODE M90584406



CODE M90584504



Included

- Brush kit



FLEXI2^{plus}



2 ANIMALS



DRY



2S+ 250D PAST1P30

With plastic bucket

CODE M90584575

2S+ 250D PAST1I25

With stainless steel bucket

CODE M91900172



2G+ 250D PAST1P30

With plastic bucket

CODE M90584574

2G+ 250D PAST1I25

With stainless steel bucket

CODE M91900173

Features

The **Flexi Plus** model is designed for demanding farmers who require a robust and reliable solution for milking one animal at a time under any operating condition.

This configuration delivers high-performance operation, powered by a high-capacity **dry vacuum pump (Model PM5) delivering 250 L/min of vacuum.**

The **15-liter galvanized vacuum tank** provides adequate vacuum reserve to ensure stable and consistent vacuum levels throughout the milking cycle.

The **Milkline-patented Pastore claw** is equipped with a special lever that allows you to choose between three operating modes: active vacuum, inactive vacuum, and automatic vacuum. The automatic vacuum mode automatically opens the vacuum only when the liners are attached to the animal's udder. At the end of milking, with a simple movement of the lever, the operator closes the vacuum for easy removal of the cluster.

The **ML120 pneumatic pulsator**—simple, reliable, and purely air-operated—requires no electrical power supply for operation.

The **Flexi Plus** model is available with either **1 transparent plastic bucket or stainless steel bucket.**

The daily cleaning brush kit is included as standard and comprises: two straight brushes (40 cm and 200 cm) and one short rotating brush.

Technical specifications of key components (Additional spare parts: page 16–24)

CODE	DESCRIPTION	SPECIFICATIONS	Q.TY	PAGE
B0170631	ML LONG CURVED SIL. LINER FOR SHEEP Ø17	SILICON, LONG, CURVED (FOR CODE M90584575/M91900172)	4	16
B0170742	ML LONG CURVED SIL. LINER FOR GOAT TG 20	SILICON, LONG, CURVED (FOR CODE M90584574/M91900173)	4	16
B0416000	PASTORE AUTOMATIC SHEEP AND GOAT CLAW	FOR SHEEP AND GOATS, PLASTIC, WITH AUTOMATIC VALVE, 100 CC CAP.	2	17
B0461786	MILKING BUCKET TRAS 30 L STD BLUE	TRANSPARENT PLASTIC, WITH HANDLE, 30 L CAP., BLUE BOTTOM (FOR CODE M90584575/574)	1	19
M3462001	25 LT STAINLESS STEEL MILK BUCKET	S/S, WITH HANDLE, 25 L CAP. (FOR CODE M91900172/173)	1	19
B0231830	ML NAKED TRANSPARENT LID 3 INLETS Ø17	TRANSPARENT PLASTIC, Ø17 MM, 3 INLETS	1	19
B02620301	RUBBER MILK TUBE ML WHITE LINE 13X23	RUBBER, WHITE LINE, MILK TUBE	5,0 M*	18
B0270683	PVC TRANSPARENT VACUUM TUBE ML BLUE LINE 7,6X14,6	PVC, TRANSPARENT, BLUE LINE, VACUUM TUBE	1,12 M*	18
B0281602	VACUUM TUBE RUB ML BLUE L. 07X14	RUBBER, BLUE LINE, VACUUM TUBE	5,4 M*	18
B02816501	RUBBER VACUUM TUBE ML BLU LINE 13X23	RUBBER, BLUE LINE, VACUUM TUBE	0,5 M*	18
B0474030	ELECTRIC VACUUM PUMP PM5 230 KW0,9 / 250L/M	PM5 MODEL, DRY, 230V, KW 0,9, CAPACITY 250 L/MIN - 50KPA - 1.400 RPM	1	21
M0481631	VACUUM GAUGE 63X1/4" DAMPENED	63X1/4"	1	24
B0390003	ALTERNATE PULSATOR ML120 50/50	PNEUMATIC, PULSATION RATIO 50/50	1	20
IR 15402	WHEEL	RIGID PLASTIC, Ø 250 MM, WITH CAP	2	24

* Total length (in meters) supplied per trolley.



CODE M90584575



CODE M90584574

FLEXI2^{plus}



2 ANIMALS



DRY



PM5
250L/MIN



15 LITER
TANK



CODE M91900172



CODE M91900173



Included

- Brush kit



FLEXI2^{plus}



2 ANIMALS



LUBRICATED



2S+ 250L PAST1 P30

With plastic bucket

CODE M91900158

2S+ 250L PAST1 I25

With stainless steel bucket

CODE M91900159



2G+ 250L PAST1 P30

With plastic bucket

CODE M91900155

2G+ 250L PAST1 I25

With stainless steel bucket

CODE M91900154

Features

The **Flexi Plus** model is designed for the most demanding livestock farmers seeking a robust and reliable solution for milking one animal at a time under any operating condition.

This configuration delivers high work performance, powered by a **250 L/min oil-lubricated electric vacuum pump (Model PM5)**.

The **15-liter galvanized vacuum tank** provides an optimal vacuum reserve to ensure stable vacuum levels throughout the milking process.

The **Milkline-patented Pastore claw** is equipped with a special lever that allows you to choose between three operating modes: active vacuum, inactive vacuum, and automatic vacuum. The automatic vacuum mode automatically opens the vacuum only when the liners are attached to the animal's udder. At the end of milking, with a simple movement of the lever, the operator closes the vacuum for easy removal of the cluster.

The **ML120 pneumatic pulsator**—simple, reliable, and purely air-operated—requires no electrical power supply for operation.

The **Flexi Plus** model is available with either **1 transparent plastic bucket or stainless steel bucket**.

A daily-cleaning brush kit is included as standard, comprising two straight brushes (40 cm and 200 cm) and one short swivel brush.

Technical specifications of key components (Additional spare parts: page 16–24)

CODE	DESCRIPTION	SPECIFICATIONS	Q.TY	PAGE
B0170631	ML LONG CURVED SIL. LINER FOR SHEEP Ø17	SILICON, LONG, CURVED (FOR CODE M91900158/159)	4	16
B0170742	ML LONG CURVED SIL. LINER FOR GOAT TG 20	SILICON, LONG, CURVED (FOR CODE M91900155/154)	4	16
B0416000	PASTORE AUTOMATIC SHEEP AND GOAT CLAW	FOR SHEEP AND GOATS, PLASTIC, WITH AUTOMATIC VALVE, 100 CC CAP.	2	17
B0461786	MILKING BUCKET TRAS 30 L STD BLUE	TRANSPARENT PLASTIC, WITH HANDLE, 30 L CAP., BLUE BOTTOM (FOR CODE M91900158/155)	1	19
M3462001	25 LT STAINLESS STEEL MILK BUCKET	S/S, WITH HANDLE, 25 L CAP. (FOR CODE M91900159/154)	1	19
B0231830	ML NAKED TRANSPARENT LID 3 INLETS Ø17	TRANSPARENT PLASTIC, Ø17 MM, 3 INLETS	1	19
B02620301	RUBBER MILK TUBE ML WHITE LINE 13X23	RUBBER, WHITE LINE, MILK TUBE	5,0 M*	18
B0270683	PVC TRANSPARENT VACUUM TUBE ML BLUE LINE 7,6X14,6	PVC, TRANSPARENT, BLUE LINE, VACUUM TUBE	1,12 M*	18
B0281602	VACUUM TUBE RUB ML BLUE L. 07X14	RUBBER, BLUE LINE, VACUUM TUBE	5,4 M*	18
B02816501	RUBBER VACUUM TUBE ML BLU LINE 13X23	RUBBER, BLUE LINE, VACUUM TUBE	0,5 M*	18
B0474030	ELECTRIC VACUUM PUMP PM5L 230 KW 0,9 / 250L/M	PM5 MODEL, LUBRICATED, 230V, KW 0,9, CAPACITY 250 L/MIN - 50KPA - 1.400 RPM	1	22
M0481631	VACUUM GAUGE 63X1/4" DAMPENED	63X1/4"	1	24
B0390003	ALTERNATE PULSATOR ML120 50/50	PNEUMATIC, PULSATION RATIO 50/50	1	20
IR 15402	WHEEL	RIGID PLASTIC, Ø 250 MM, WITH CAP	2	24

* Total length (in meters) supplied per trolley.



CODE M91900158



CODE M91900155

FLEXI2^{plus}



2 ANIMALS



LUBRICATED



PM5L
250L/MIN



15 LITER
TANK



CODE M91900159



CODE M91900154



Included

- Brush kit
- 1L oil

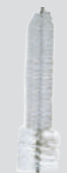

40 CM



200 CM

FLEXI4



4 ANIMALS



LUBRICATED



4S 450L PAST 2 P30

With plastic bucket

CODE M91900164

4S 450L PAST 2 I25

With stainless steel bucket

CODE M91900165



4G 450L PAST 2 P30

With plastic bucket

CODE M91900161

4G 450L PAST 2 I25

With stainless steel bucket

CODE M91900162

Features

This version of the **Flexi Plus** model is designed for demanding farmers who require a robust and reliable solution for simultaneous milking of two animals, with two separate milk buckets for independent collection.

This configuration delivers high-performance operation, powered by a high-capacity **oil-lubricated vacuum pump (Model PM6) delivering 450 L/min of vacuum**, engineered for minimal maintenance requirements and extended service life.

The **20-liter galvanized vacuum tank** provides substantial vacuum reserve capacity to ensure stable and consistent vacuum levels throughout the milking cycle, even under dual-unit operation.

The **Milkline-patented Pastore claw** is equipped with a special lever that allows you to choose between three operating modes: active vacuum, inactive vacuum, and automatic vacuum. The automatic vacuum mode automatically opens the vacuum only when the liners are attached to the animal's udder. At the end of milking, with a simple movement of the lever, the operator closes the vacuum for easy removal of the cluster.

The **ML120 pneumatic pulsator**—simple, reliable, and purely air-operated—requires no electrical power supply for operation.

The **Flexi2 Plus** trolley is available with either with either **2 transparent plastic buckets or stainless steel buckets**.

The daily cleaning brush kit is included as standard and comprises: two straight brushes (40 cm and 200 cm) and one short rotating brush.

Technical specifications of key components (Additional spare parts: page 16–24)

CODE	DESCRIPTION	SPECIFICATIONS	Q.TY	PAGE
B0170631	ML LONG CURVED SIL. LINER FOR SHEEP Ø17	SILICON, LONG, CURVED (FOR CODE M91900164/165)	4	16
B0170742	ML LONG CURVED SIL. LINER FOR GOAT TG 20	SILICON, LONG, CURVED (FOR CODE M91900161/162)	4	16
B0416000	PASTORE AUTOMATIC SHEEP AND GOAT CLAW	FOR SHEEP AND GOATS, PLASTIC, WITH AUTOMATIC VALVE, 100 CC CAP.	2	17
B0461786	MILKING BUCKET TRAS 30 L STD BLUE	TRANSPARENT PLASTIC, WITH HANDLE, 30 L CAP., BLUE BOTTOM (FOR CODE M91900164/161)	1	19
M3462001	25 LT STAINLESS STEEL MILK BUCKET	S/S, WITH HANDLE, 25 L CAP. (FOR CODE M91900165/162)	1	19
B0231830	ML NAKED TRANSPARENT LID 3 INLETS Ø17	TRANSPARENT PLASTIC, Ø17 MM, 3 INLETS	1	19
B02620301	RUBBER MILK TUBE ML WHITE LINE 13X23	RUBBER, WHITE LINE, MILK TUBE	10 M*	18
B0270683	PVC TRANSPARENT VACUUM TUBE ML BLUE LINE 7,6X14,6	PVC, TRANSPARENT, BLUE LINE, VACUUM TUBE	2,4 M*	18
B0281602	VACUUM TUBE RUB ML BLUE L. 07X14	RUBBER, BLUE LINE, VACUUM TUBE	10 M*	18
B02816501	RUBBER VACUUM TUBE ML BLU LINE 13X23	RUBBER, BLUE LINE, VACUUM TUBE	1,0 M*	18
B0474050	ELECTRIC VACUUM PUMP PM6L 230 KW1,3/450L/M	PM6 MODEL, LUBRICATED, 230V, KW1,3, CAPACITY 450 L/MIN - 50KPA - 1.400 RPM	1	22
M0481631	VACUUM GAUGE 63X1/4" DAMPENED	63X1/4"	1	24
B0390003	ALTERNATE PULSATOR ML120 50/50	PNEUMATIC, PULSATION RATIO 50/50	1	20
IR 15402	WHEEL	RIGID PLASTIC, Ø 250 MM, WITH CAP	2	24

* Total length (in meters) supplied per trolley.



CODE M91900164



CODE M91900161

FLEXI4



4 ANIMALS



LUBRICATED

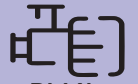

PM6L
450L/MIN



20 LITER
TANK



CODE M91900165



CODE M91900162



Included

- Brush kit
- 1L oil

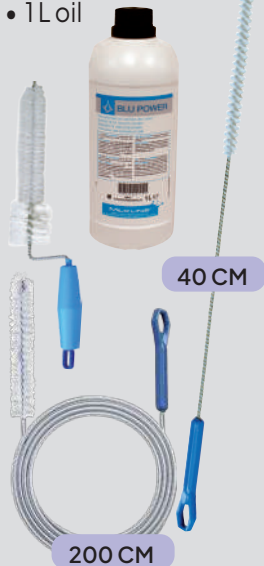

40 CM

200 CM



COMPONENTS AND SPARE PARTS

LINERS AND TEAT CUP SHELLS

COD. B0170631



**ML SILICON LINER FOR SHEEP
CURVED L D.17**

Mold code: 911181-1

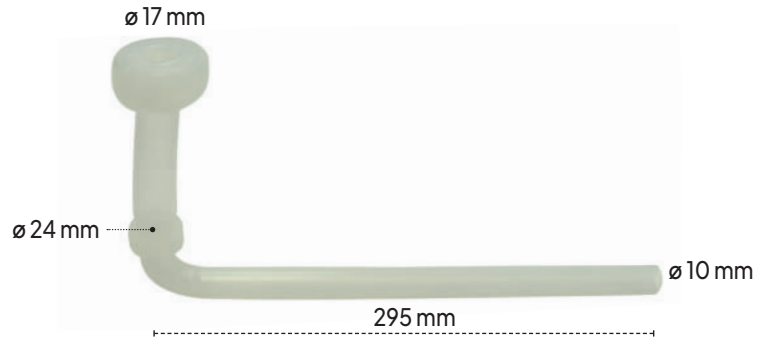

COD. B0170742



**ML SILICON LINER FOR GOATS
CURVED L TG20**

Orig.: SCR-03

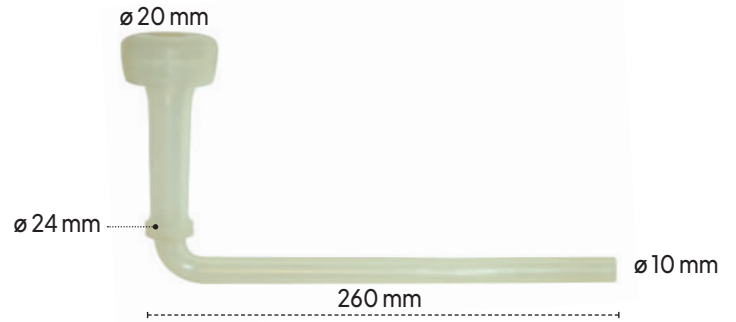

COD. B0460318



PLASTIC TEAT CUP SHELL ML

Weight: 50 g

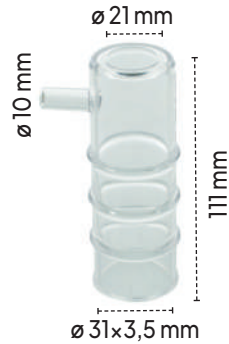

COD. B0460415



PLASTIC TEAT CUP SHELL ML

Weight: 76 g



CLAWS

COD. B0410522

ML/OC PLASTIC CLAW WITH VALVE, WITH HOLE - 150 CC

Capacity	150 cc
Milk outlet (A)	ø 16 x 19 mm
Milk inlet nipple (B)	ø 7,5 x 14 mm
Total weight	g 184



**SPARE PARTS FOR ML/OC PLASTIC CLAW WITH VALVE,
WITH HOLE - 150 CC.**

CODE	DESCRIPTION	REF.
B0202300	Plastic Y 10x10x10	1
B0410523	Transparent upper part with hole	2
B0410532	Blue silicon gasket	3
M04148252	Complete closure	4
B0410528	Only claw bowl, 150 cc with valve	5
B0410533	Blue rubber cap for closure	6
M04105282	Complete claw bowl, 150 cc with valve	7= 3+4+5+6

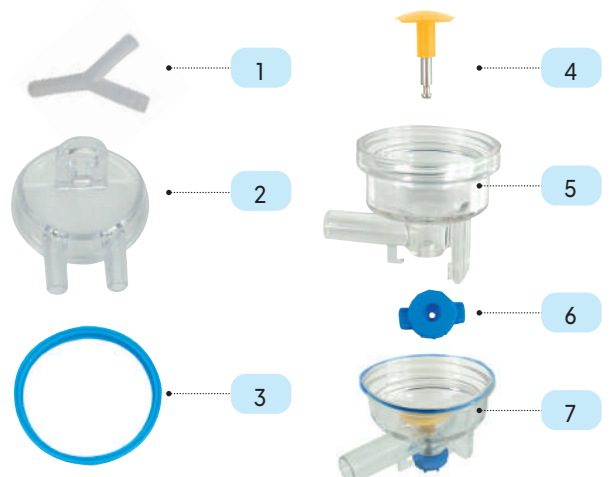



COD. B0416000

PASTORE AUTOMATIC PLASTIC CLAW 100 CC

Capacity	100 cc
Milk outlet (A)	ø 14 x 18 mm
Milk inlet nipple (B)	ø 9 x 13 mm
Pulsation nipple (C)	ø 5 x 10 mm
Total weight	g 148

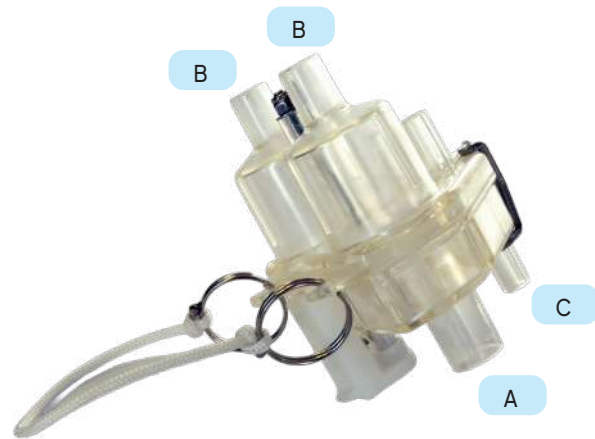

SPARE PARTS FOR PASTORE AUTOMATIC PLASTIC CLAW FOR SHEEP AND GOATS, 100 CC

CODICE	DESCRIZIONE	RIF.
B0416030	Lower part	1
B0413244	Rope for milking group	2
B0410505	S/S ring ø 25	3
B0416028	Closing valve	4
B0416026	Silicon diaphragm	5
B04160241	Valve-lifter plate NT	6
B0416022	Lower part for selector	7
B0416018	Upper part	8
B0416014	S/S ball for selector	9
B0416016	Selector spring	10
B0416032	S/S closing clip	11
B0416012	Auto/manual switch	12
B0416010	Switch screw	13
B0416020	S/S screw M4 for 75	14
B0416040	Calibrated cap (Optional)	15

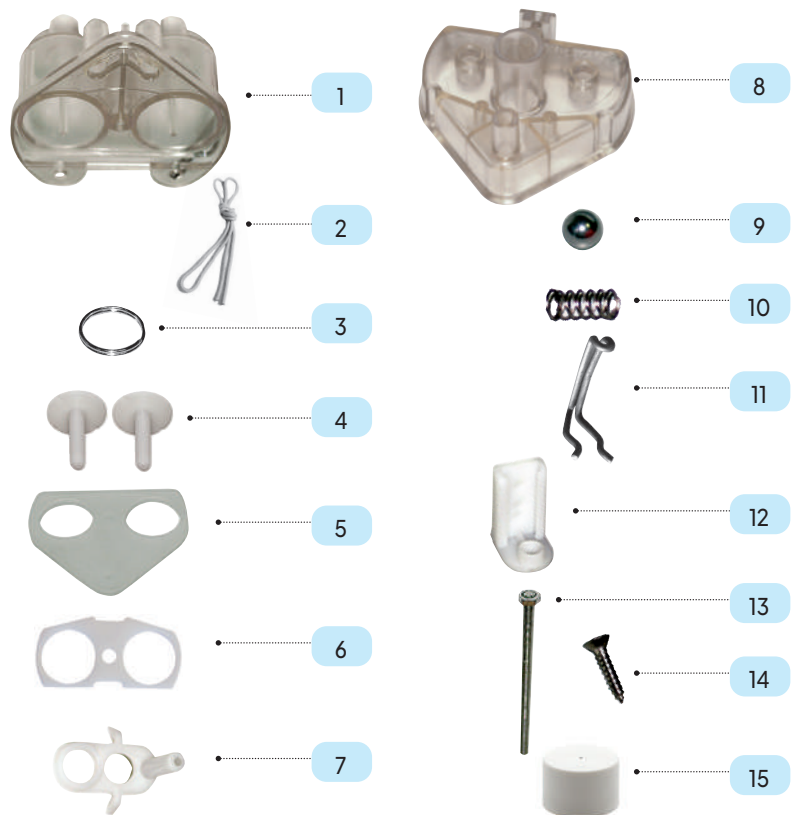

HOW TO USE THE VACUUM CONTROL LEVER

- POSITION 1: Closed Vacuum**
Milking and washing are not possible.
- POSITION 2: Automatic vacuum**
The vacuum is automatically activated when the liners come into contact with the teats.
- POSITION 3: Open vacuum**
Select this position for washing.

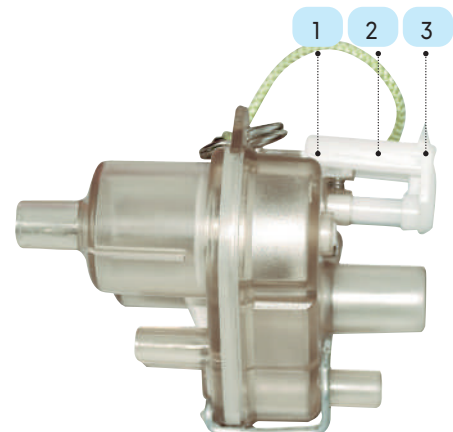

For further details, refer to the Quick Guide supplied with the claw.



COMPONENTS AND SPARE PARTS

MILK TUBE

COD. B02620301

RUBBER MILK TUBE ML WHITE LINE 13X23

Ø Internal	13 mm
Ø External	23 mm
Lenght	25 m Roll*
Material	Black rubber



OPERATING TEMPERATURE
PVC and black rubber: -25°C to +110°C



* The item code corresponds to a 25-meter roll. Also available by the linear meter.

VACUUM TUBE

COD. B0270683

TRANSPARENT PVC VACUUM TUBE ML BLUE LINE 7,6X14,6

Ø Internal	7,6 mm
Ø External	14,6 mm
Lenght	50 m Roll*
Material	Transparent PVC



OPERATING TEMPERATURE
PVC and black rubber: -25°C to +110°C



* The item code corresponds to a 50-meter roll. Also available by the linear meter.

COD. B0281602

RUBBER VACUUM TUBE ML BLUE LINE 7X14

Ø Internal	7 mm
Ø External	14 mm
Lenght	25 m Roll*
Material	Black PVC



OPERATING TEMPERATURE
PVC and black rubber: -25°C to +110°C



* The item code corresponds to a 25-meter roll. Also available by the linear meter.

COD. B02816501

RUBBER VACUUM TUBE ML BLUE LINE 13X23

Ø Internal	13 mm
Ø External	23 mm
Lenght	25 m Roll*
Material	Black rubber



OPERATING TEMPERATURE
PVC and black rubber: -25°C to +110°C



* The item code corresponds to a 25-meter roll. Also available by the linear meter.

COD. B0282300

RUBBER O-RING FOR COUPLING TUBES





BUCKETS

CODE B0461786

30 L STD TRANSPARENT PLASTIC MILKING BUCKET - BLUE BOTTOM COLOR

Scale	Liters and gallons	External ø (A)	188,5 mm
Capacity	30 L	Internal ø (A)	174,5 mm
Weight	3,4 Kg	Height (H)	578 mm
Handle	Inox	Height (L)	141,5 mm
Base ø (D)	374 mm	Height (M)	427,5 mm

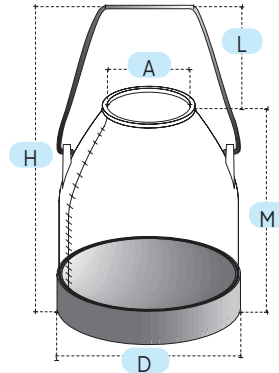

CODE B0461840 S/S HANDLE (1)

CODE M3462001*

25 L STAINLESS STEEL MILKING BUCKET

Scale	-	Base ø (D)	335 mm
Capacity	25 L	Opening ø (A)	190 mm
Weight	4,5 Kg	Height (H)	415 mm
Handle	Stainless steel	Height (L)	145 mm
Material	Stainless steel		

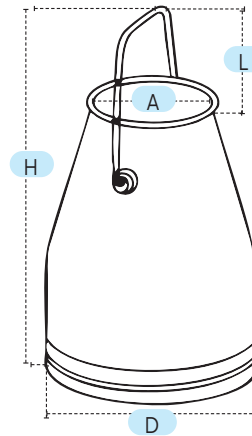

*The data for the stainless-steel bucket may be subject to change.

LIDS AND GASKETS



CODE	DESCRIPTION	30 L	25 L	REF.
B0231600	Ø 19 MM PLASTIC LID (ONLY FOR ECONOMY MODEL)	✓	✓	1
B0220720	WASHER FOR PLASTIC LID (FOR B0231600)	✓	✓	2
B0231810	BARE TRANSPARENT LID 2 INLETS Ø 17 MM	✓	✓	3
B0231830	BARE TRANSPARENT LID 3 INLETS - Ø 17 MM	✓	✓	4
B0311410	INTERNAL VALVE FOR BALL			5
B0231844	FILTER FOR ML LID WITH 2/3 INLETS			6
B0212860	STD ML BLACK RUBBER GASKET LID	✓	✓	7
B02128601	SILICON BLUE GASKET LID	✓	✓	8

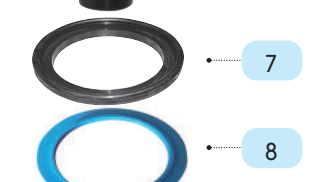
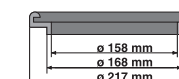
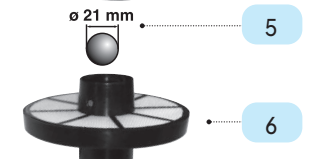
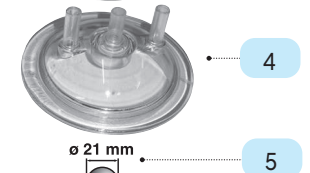
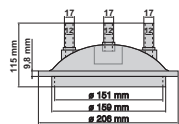
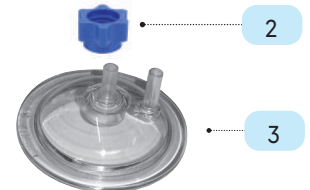
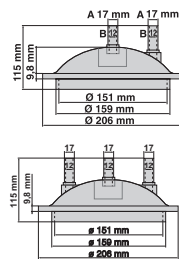
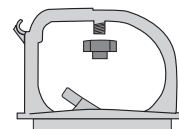



PULSATOR AND ACCESSORIES

CODE B0390003

ML120 50/50 PULSATOR

Pulsation frequency	50 /180 ppm
Pulsation ratio	50/50
Operating system	Pneumatic (Diaphragm)
Dimensions (L x W x H)	92 x105 x 65 mm
Weight	300 g



SPARE PARTS FOR ML120 60/40 PULSATOR

CODE	DESCRIPTION	REF.
B0390024	Fixing screw for upper lid	01
B0391699	Screw for plate dowel	02
B0391698	Base plate dowel	03
B0391640	Front shaft	12
B0390025	Main body puls. ML120	14
B0391626	Synthetic plate pulsator	16
B0391628	Screw for base platel	17
B0390011	Main drawer puller	31
B0390017	Main drawer 60/40 alternate	32
M0390010	Diaphragm cover ring	33
B0390014	Puller for rev valve	35
B0390015	Reverse valve	36
B0390016	Speed regulator pin	37
B0390018	Main drawer 50/50 alt.	41
B0390019	Main drawer 70/30 alt.	42
B0390020	Main drawer 65/35 alt.	43
B0390021	Lateral lid right	44
B0390022	Lateral lid left	45
B0390023	Upper lid	46
B0391627	Gasket for plate	48
B0391619	Plunger bushing	49
B0391623	Fixing screw lateral lid	300
B0391642	O-ring for puls. rotor seal	325
B0391631	Puls.main diaphragm	326
B0391636	Central shaft	327
B0391637	Reverse diaphragm	328

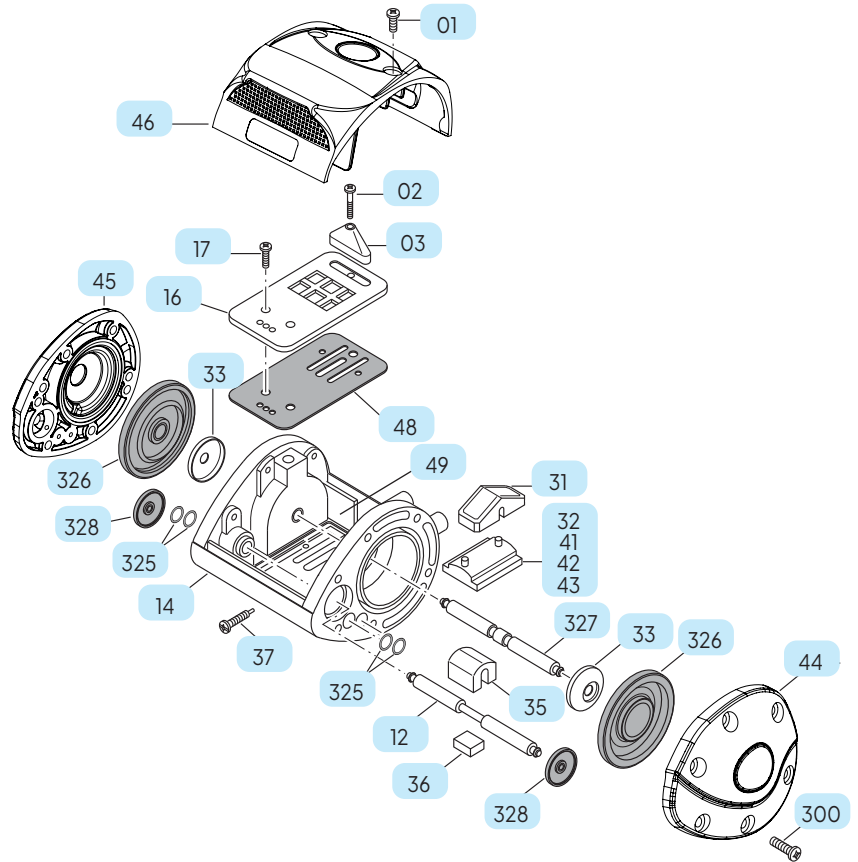

CODE B0390031

**ML120 50/50
REPLACEMENT KIT**



CODE B0400011

**IP/ORION FITTING FOR
STD VACUUM COCK**

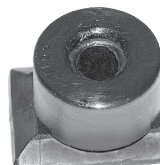

COD. B0400020

**IP/ORION FITTING FOR
S/S BUCKET LID AL**





DRY VACUUM PUMPS



CODE B0474010

ELECTRIC VACUUM PUMP PM3/230 - KW0,37 - 140L/M

Flow Rate (L/min at 50 kPa)	140
Speed (RPM)	1400
Motor Power (kW)	0,37
Voltage / Frequency (V/Hz)	230/50



CODE B0476000

1/2" DRY GALVANIZED SILENCER



CODE B0330110*

GRAPHITE VANE 55X37X5 (PM3)



**The code refers to a single piece. It is recommended to order a set of 4 pieces.*

CODE B0474020

ELECTRIC VACUUM PUMP PM4/230 - KW0,75 - 190L/M

Flow Rate (L/min at 50 kPa)	190
Speed (RPM)	1400
Motor Power (kW)	0,75
Voltage / Frequency (V/Hz)	230/50



CODE B0476000

1/2" DRY GALVANIZED SILENCER



CODE B0330115*

GRAPHITE VANE 70X44X5 (PM4)



CODE B0330120*

GRAPHITE VANE 70X44X6 (PM4)

**The code refers to a single piece. It is recommended to order a set of 4 pieces.*

CODE B0474030

ELECTRIC VACUUM PUMP PM5/230 - KW0,9 - 250L/M

Flow Rate (L/min at 50 kPa)	250
Speed (RPM)	1400
Motor Power (kW)	0,90
Voltage / Frequency (V/Hz)	230/50



CODE B0476010

3/4" DRY GALVANIZED SILENCER



CODE B0330132*

GRAPHITE VANE 60X52,5X6 (PM5)



**The code refers to a single piece. It is recommended to order a set of 4 pieces.*



COMPONENTS AND SPARE PARTS

LUBRICATED VACUUM PUMPS



CODE B0474040

ELECTRIC VACUUM PUMP PM5L/230 - KW0,9 - 250L/M

Flow Rate (L/min at 50 kPa)	250
Speed (RPM)	1400
Motor Power (kW)	0,9
Voltage / Frequency (V/Hz)	230/50



CODE B03301501*

KEVLAR VANE PM5L/6L 60X51



**The code refers to a single piece. It is recommended to order a set of 4 pieces.*

CODE B0474050

ELECTRIC VACUUM PUMP PM6L/230 KW1,3 - 450L/M

Flow Rate (L/min at 50 kPa)	450
Speed (RPM)	1415
Motor Power (kW)	1,3
Voltage / Frequency (V/Hz)	230/50



CODE B03301501*

KEVLAR VANE PM5L/6L 60X51



**The code refers to a single piece. It is recommended to order a set of 4 pieces.*

VANES

CODE	DESCRIPTION	PUMP
B0330110	55X37X5 GRAPHITE VAN	PM3
B0330115	70X44X5 GRAPHITE VAN	PM4
B0330120	70X44X6 GRAPHITE VAN	PM4
B0330132	60X52,5X6 GRAPHITE VAN	PM5
B03301501	60X51 KEVLAR VAN	PM5L-PM6L





VACUUM PUMP OIL

CODE B0300610

BLU POWER OIL
1L BOTTLE

CODE B0300710

BLU POWER OIL
5 L CAN

CODE B0300800

BLU POWER WINTER OIL
5 L CAN



VACUUM ACCESSORIES

CODE B0472070

MILKLINE COMPLETE OILER

SPARE PARTS FOR COMPLETE OILER MILKLINE

CODE	DESCRIPTION	REF.
B0472076	Bare base	1
B0472082	Inner part for oiler pin	2
B0472074	Middle body	3
B0472078	Capillar	4
B0472071	500 ml Hexagonal container ø 34.5 mm	5
B0472084	Level adjusting screw	6
B0472080	M5 Suction pin	7

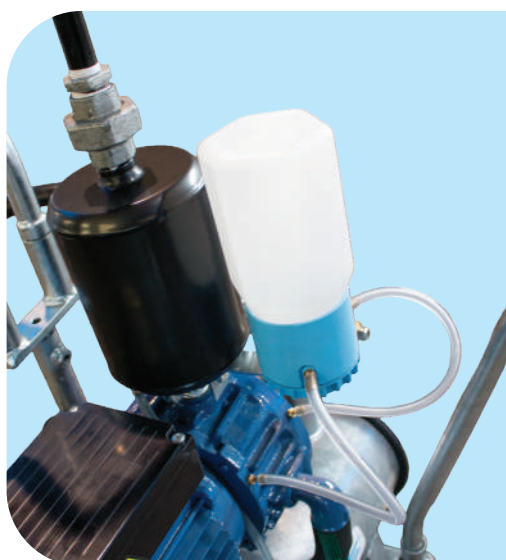
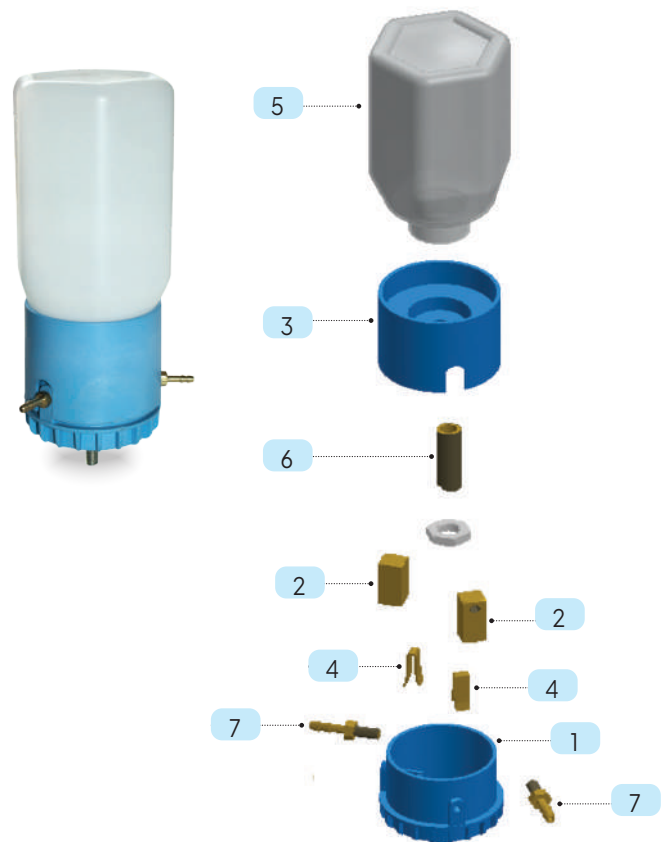

BLU POWER OIL – TECHNICAL FEATURES

- The high viscosity index ensures reliable cold-flow performance and improved vacuum pump startup.
- Maintains optimal physical properties across a wider operating temperature range.
- Enhanced raw materials provide greater operational stability. (reduced performance degradation over time).
- Color: blue.

Alternatively, **BLU POWER WINTER OIL** features a significantly higher viscosity, index, maintaining fluidity even at sub-zero temperatures. Ideal for cold environments, preventing freezing and thickening.



COMPONENTS AND SPARE PARTS

VACUUM ACCESSORIES

CODE B0480220

3/4" BRASS SPRING REGULATING VALVE



CODE B0220400

MUSHROOM VALVE, Ø 25



CODE B0480250

1" MILKLINE SPRING REGULATING VALVE



CODE M0481631

63 MM DAMPED VACUUM GAUGE 1/4"



CODE B0230500

15 L/20 L VACUUM TANK CLOSED LID



CODE B0211330

15 L/20 L VACUUM TANK LID GASKET



CODE B0470410

FLAP DOOR + GASKET FOR 12 L TROLLEY TANK



COD. B0470100

TROLLEYS GRIP HANDLE 3/4" D.27

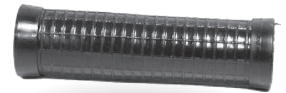

CODE B0320100

1/2" THREADED STRAIGHT VACUUM COCK

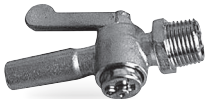

CODE B0320200

1/2" THREADED CURVED VACUUM COCK



CODE B0320300

1" THREADED CURVED VACUUM COCK



CODE B0476016

COMPLETE 3/4" LUBRICATED MUFFLER



CODE B0476018

COMPLETE 1" LUBRICATED MUFFLER



CODE B0476017

MUFFLER EXHAUST FOR 3/4" (B0476016) AND 1" (B0476018)



CODE B0310700

1" PUMP CONNECTION SLEEVE, LENGTH 300 MM



CODE B0370110

CLOSED RUBBER END CAP, Ø 30 MM



CODE IR15402

RIGID PLASTIC WHEELS, WITH CIRCLIP AND CAP



PRODUCT RANGE OVERVIEW: KEY SPECIFICATIONS AND PERFORMANCE DATA

Review the table below to identify the optimal configuration for your operation, based on herd size and specific workflow requirements.



1 ANIMAL

CODE	DESCRIPTION	BUCKET NUMBER	MILK UNIT NUMBER	MILKCLAW	BUCKET TYPE	PUMP	LITER PUMP	PUMP TYPE	TANK CAPACITY
B90583900	ECONOMY 1S 140D PAST 1 P30	1	1	PASTORE	PLASTIC 30 L	PM3	140	DRY	5 L
B90583902	ECONOMY 1S 140D PAST 1 I25	1	1	PASTORE	S/S 25 L	PM3	140	DRY	5 L
B90583950	ECONOMY 1G 140D PAST 1 P30	1	1	PASTORE	PLASTIC 30 L	PM3	140	DRY	5 L
B90583952	ECONOMY 1G 140D PAST 1 I25	1	1	PASTORE	S/S 25 L	PM3	140	DRY	5 L
M90580303	COMPACT 1S 140D PAST 1 P30	1	1	PASTORE	PLASTIC 30 L	PM3	140	DRY	12 L
M90580304	COMPACT 1S 140D PAST 1 I25	1	1	PASTORE	S/S 25 L	PM3	140	DRY	12 L
M90580301	COMPACT 1G 140D PAST 1 P30	1	1	PASTORE	PLASTIC 30 L	PM3	140	DRY	12 L
M90580302	COMPACT 1G 140D PAST 1 I25	1	1	PASTORE	S/S 25 L	PM3	140	DRY	12 L



2 ANIMALS

M90584405	FLEXI 2S 190D ML/OC150 1 P30	1	2	ML/OC150	PLASTIC 30 L	PM4	190	DRY	15 L
M90584406	FLEXI 2S 190D ML/OC150 1 I25	1	2	ML/OC150	S/S 25 L	PM4	190	DRY	15 L
M90584503	FLEXI 2G 190D ML/OC150 1 P30	1	2	ML/OC150	PLASTIC 30 L	PM4	190	DRY	15 L
M90584504	FLEXI 2G 190D ML/OC150 1 P30	1	2	ML/OC150	S/S 25 L	PM4	190	DRY	15 L
M90584575	FLEXI 2S+ 250D PAST 1 P30	1	2	PASTORE	PLASTIC 30 L	PM5	250	DRY	15 L
M91900172	FLEXI 2S+ 250D PAST 1 I25	1	2	PASTORE	S/S 25 L	PM5	250	DRY	15 L
M90584574	FLEXI 2G+ 250D PAST 1 P30	1	2	PASTORE	PLASTIC 30 L	PM5	250	DRY	15 L
M91900173	FLEXI 2G+ 250D PAST 1 I25	1	2	PASTORE	S/S 25 L	PM5	250	DRY	15 L
M91900158	FLEXI 2S+ 250L PAST 1 P30	1	2	PASTORE	PLASTIC 30 L	PM5	250	LUBRICATED	15 L
M91900159	FLEXI 2S+ 250L PAST 1 I25	1	2	PASTORE	S/S 25 L	PM5	250	LUBRICATED	15 L
M91900155	FLEXI 2G+ 250L PAST 1 P30	1	2	PASTORE	PLASTIC 30 L	PM5	250	LUBRICATED	15 L
M91900154	FLEXI 2G+ 250L PAST 1 I25	1	2	PASTORE	S/S 25 L	PM5	250	LUBRICATED	15 L



4 ANIMALS

M91900164	FLEXI 4S 450L PAST 2 P30	2	4	PASTORE	PLASTIC 30 L	PM6	450	LUBRICATED	20 L
M91900165	FLEXI 4S 450L PAST 2 I25	2	4	PASTORE	S/S 25 L	PM6	450	LUBRICATED	20 L
M91900161	FLEXI 4G 450L PAST 2 P30	2	4	PASTORE	PLASTIC 30 L	PM6	450	LUBRICATED	20 L
M91900162	FLEXI 4G 450L PAST 2 I25	2	4	PASTORE	S/S 25 L	PM6	450	LUBRICATED	20 L











Still deciding? Contact us, our experts are ready to assist with customized technical guidance.

LOGISTICS EFFICIENCY AND GLOBAL SHIPPING

The quality and versatility of our milking trolleys extend beyond the barn and are also reflected in our packaging and transport solutions. To ensure each trolley arrives in perfect condition and to optimize shipping costs, we have standardized our packaging on 60 x 80 cm or 75 x 75 cm pallets.

For high-volume orders, this pallet solution enables extremely efficient and secure container loading. The compact pallet dimensions are specifically designed to eliminate wasted space, protect the mechanical integrity of each component, and simplify handling with forklifts.

Whether shipping a single trolley or a full supply, Milkline provides maximum protection and streamlined logistics for distributors worldwide.

MODEL	FOR SINGLE ORDERS	FOR MULTIPLE-TROLLEY ORDERS			
	 N° OF TROLLEYS PER CARTON	 N° OF TROLLEYS PER CARTON	 N° OF CARTONS PER PALLET	 20 feet N° OF PALLETS/TROLLEYS PER CONTAINER	 40 feet N° OF PALLETS/TROLLEYS PER CONTAINER
 ECONOMY	1/2	2	3	21 / 126	45 / 270
 COMPACT	1/2	2	3	21 / 126	45 / 270
 FLEXI2	1	1	3	21 / 63	45 / 135
 FLEXI4	1	1	3	21 / 63	45 / 135

Included with each trolley:

- Technical manual
- CE certification
- Set of cleaning brushes
- 1 L bottle of oil
(where applicable by model)

Shrink-film packaging

Maximum Stability and Protection

Each pallet is secured with a shrink-fit plastic hood that anchors the goods to the pallet.

Total protection:

Seals the load against dust, rain and moisture.

Security:

Protects against tampering and theft during transit.

Visibility:

Transparent polyethylene allows quick visual inspection of contents.





OnlineStore

MILKLINE

Milkline Store is an exclusive web portal for our Customers — check real-time prices and stock, discover the best promotions instantly, and place and track orders with complete ease. A powerful platform designed to make your work faster and more efficient:

1. Add products to your cart and send your order with a single click
2. Our dedicated Order Desk gives your order priority handling
3. Receive prompt order confirmation and monitor fulfillment directly from the site

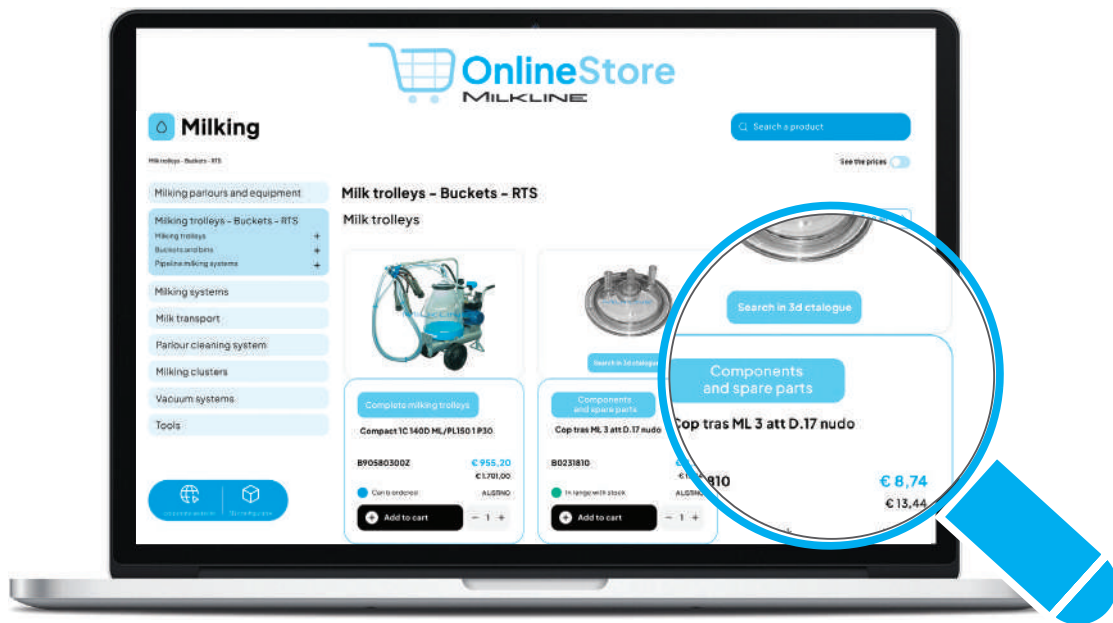

EXTRA 2% DISCOUNT
on all orders placed through the portal!

www.milkline.com/store
The easiest way to order.

MILKLINE

Via Mattei, 2
29027, Podenzano (PC) Italy
+39 0523 524245
export@milcline.com
milcline.com

